

## Multi purpose space

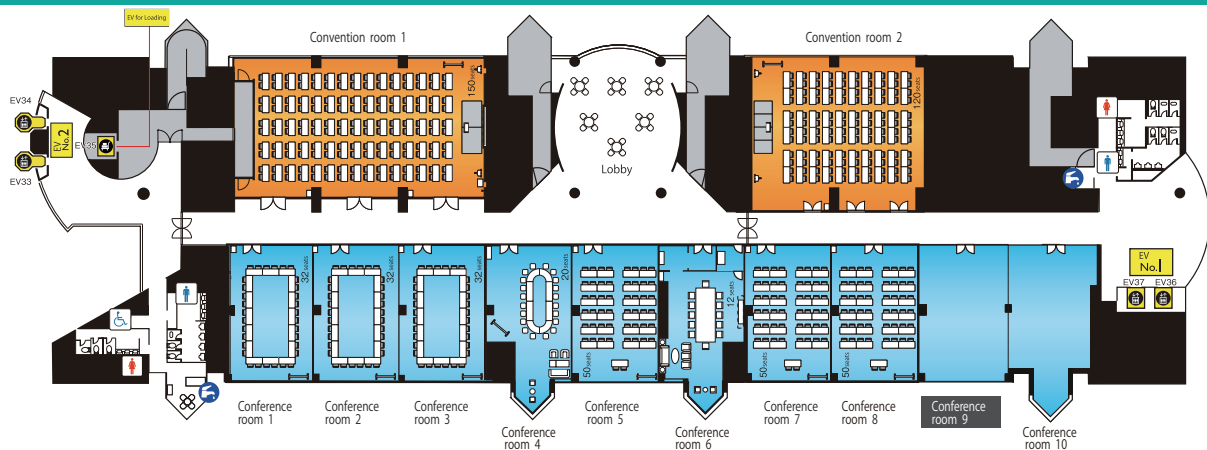

Standard Layout ▶

Ceiling height 2.8m



We offer the password to organizer.

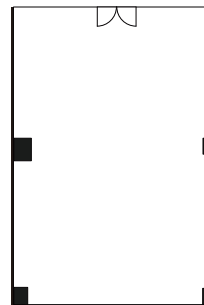

D12.4m

W7.4m



## Pre-installed Equipments <included in the room charge>



1 Sign board  
H900 \* H350mm

## Layout samples

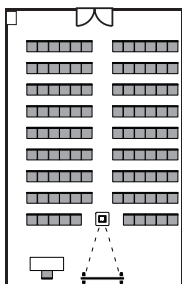

▲ Theatre 106 seats

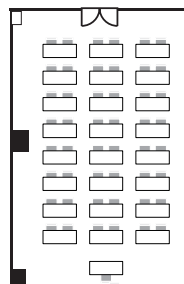

▲ Examination 48 seats

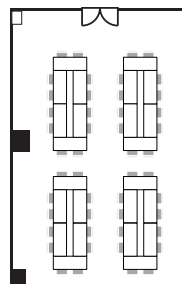

▲ Island 4 gropes

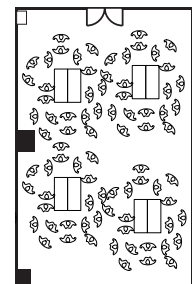

▲ Party 80 pax

◆ GET IN TOUCH

+81-6-6615-5006

✉ atchall@atc-co.com